

**MURETA 44 concreto armado revestida de pedra**

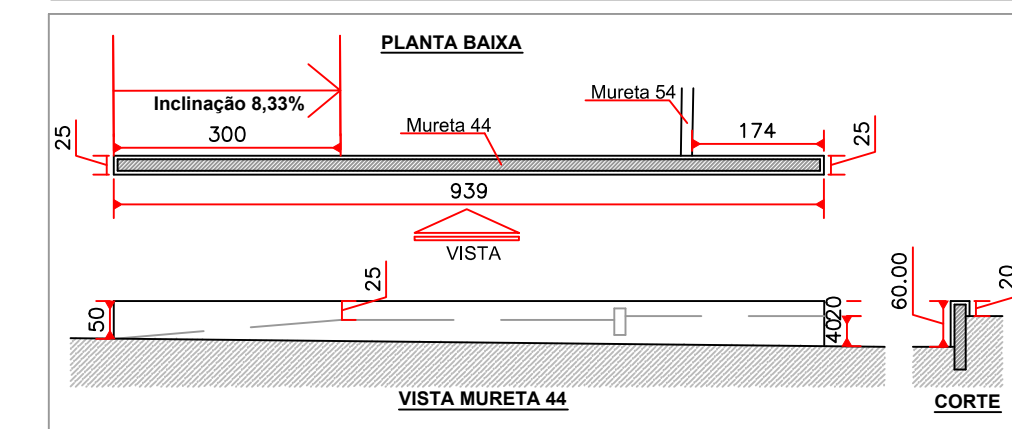

**MURETAS 50 - 51 - concreto armado**

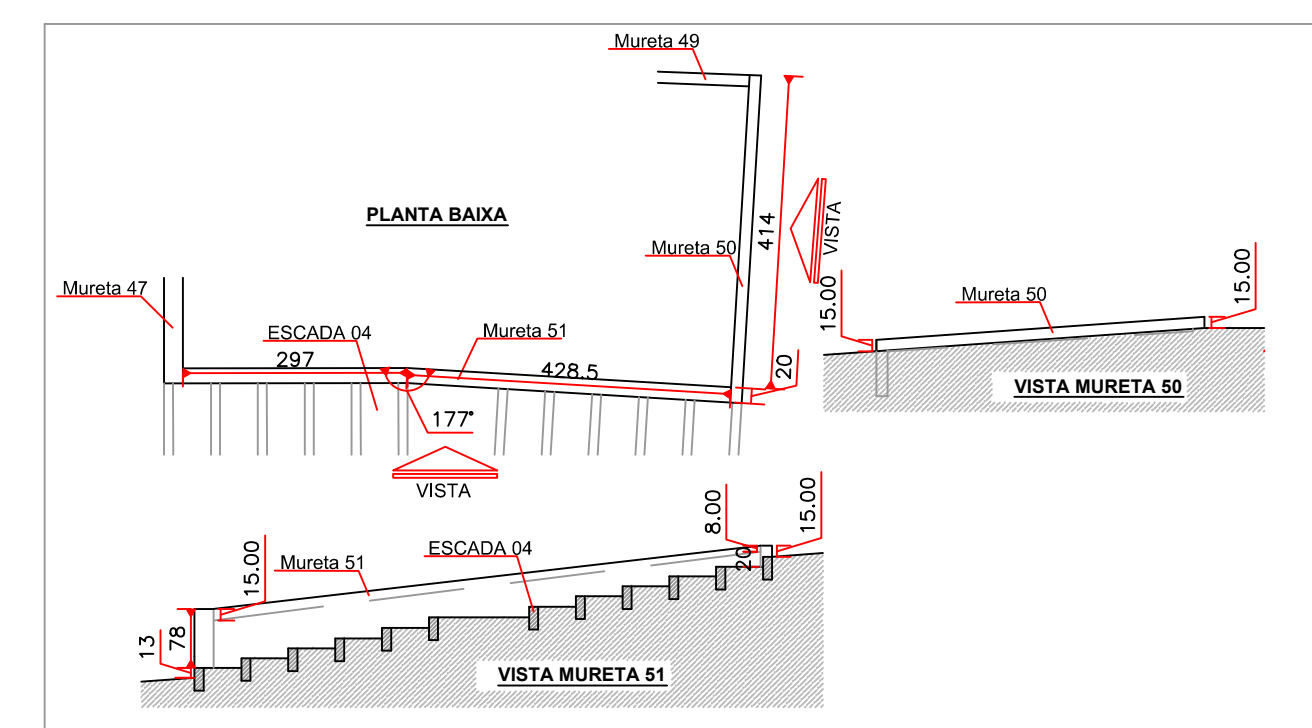

**MURETAS 45 - 46 - 47 - concreto armado revestida de pedra**

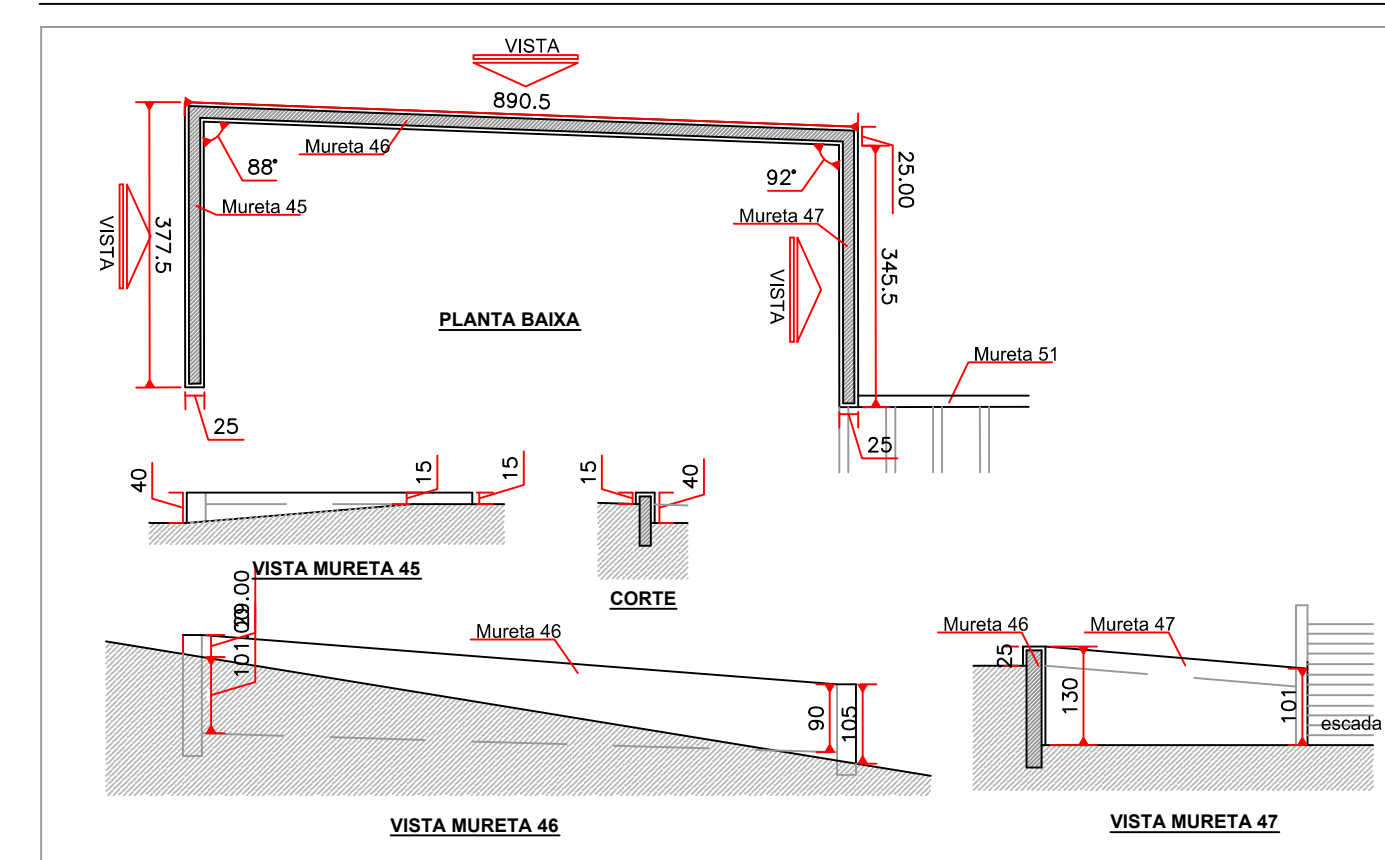

**MURETAS 48 - 49 - concreto armado**

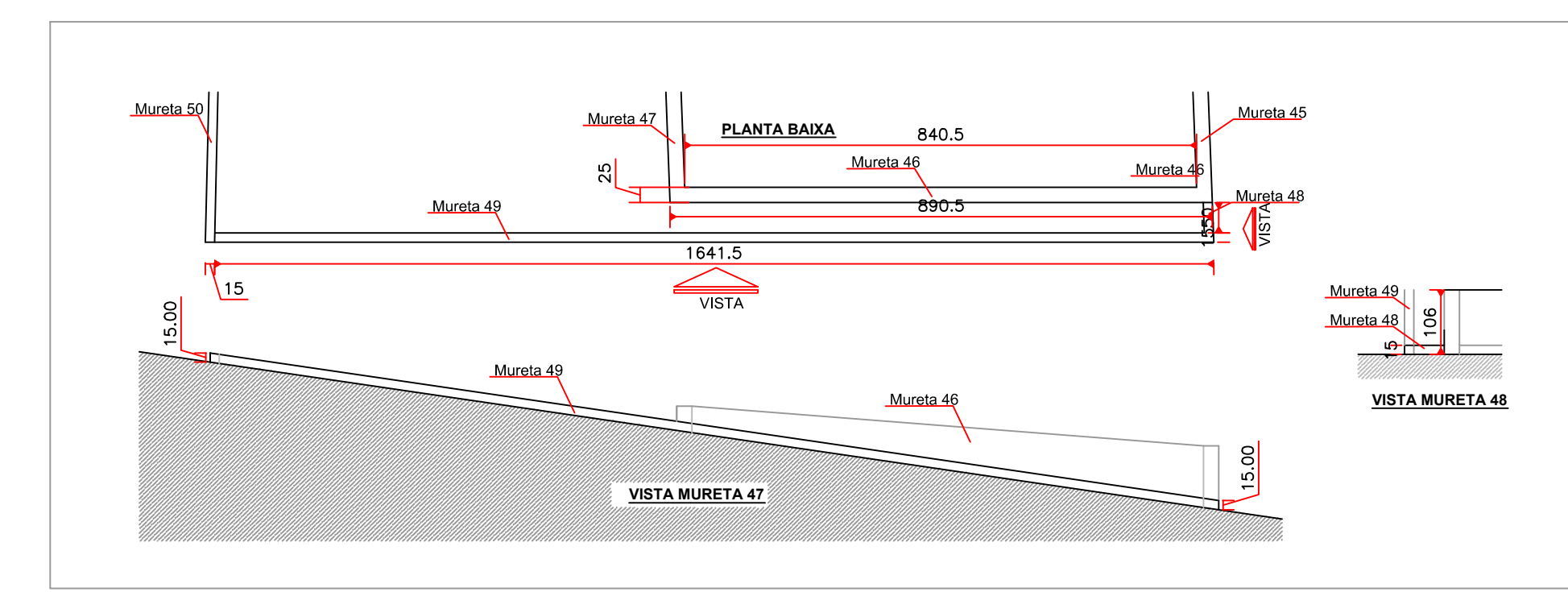

**MURETA 52 - concreto armado**

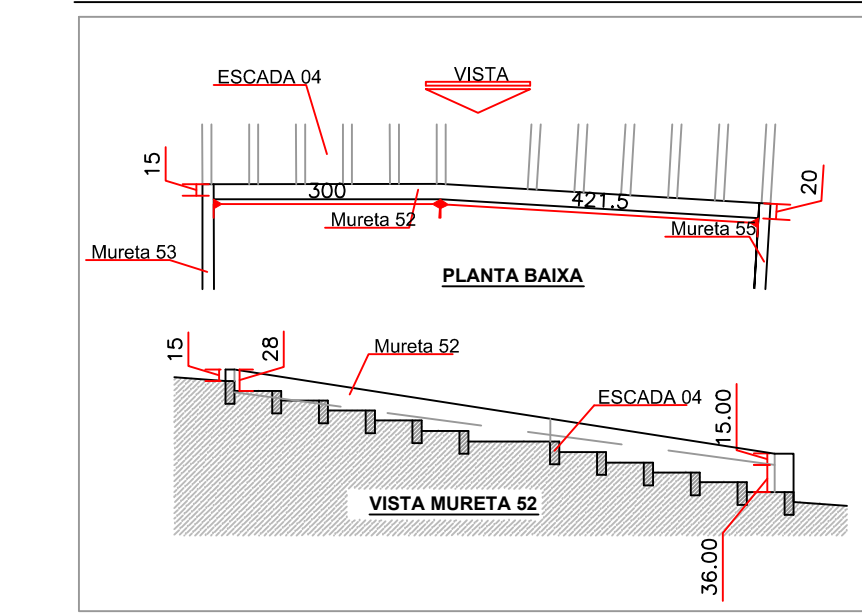

**MURETAS 53 - 54 - concreto armado**

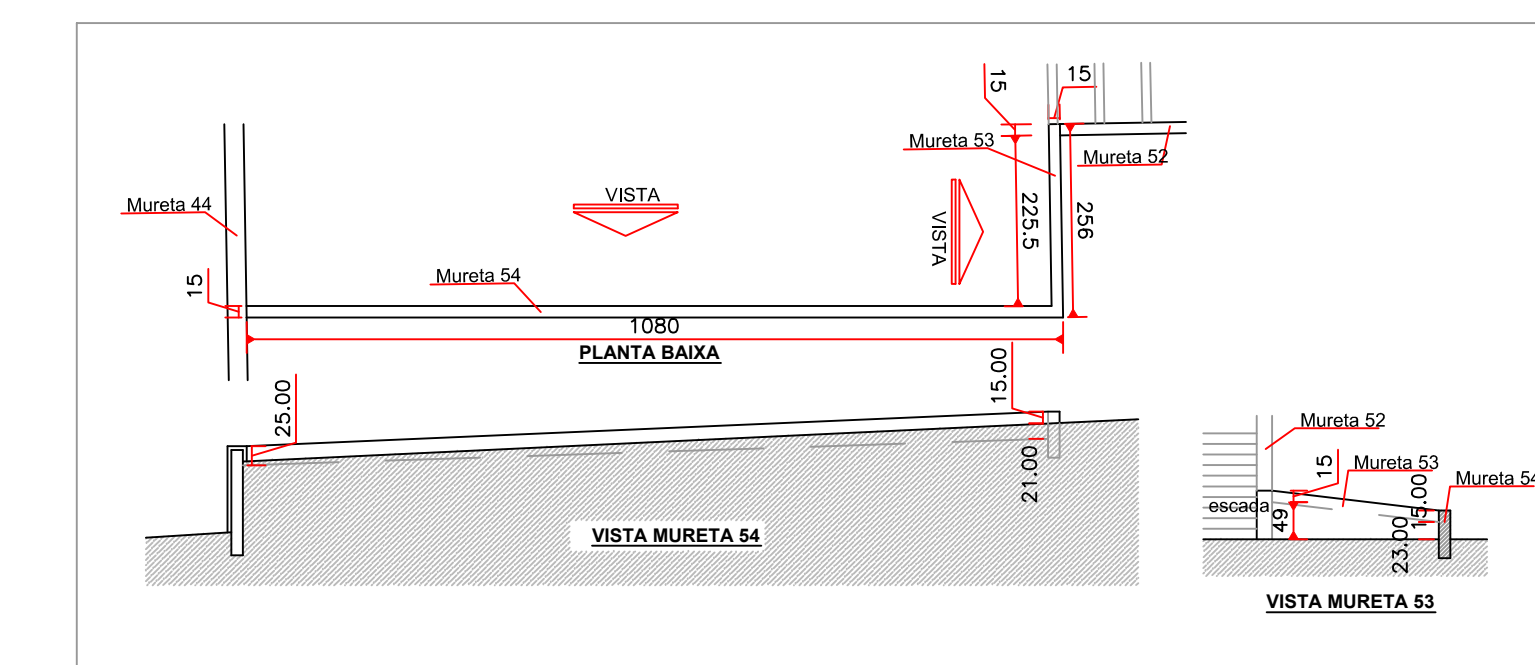

**MURETAS 55 - concreto armado**

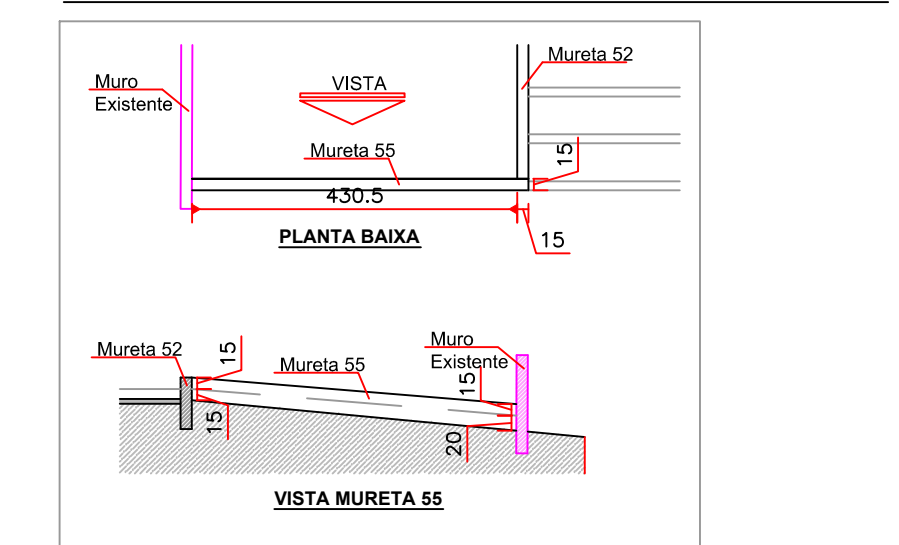

**MURETAS 56 - 57 - 58 - 59 de concreto e 60 concreto armado revestida de pedra**

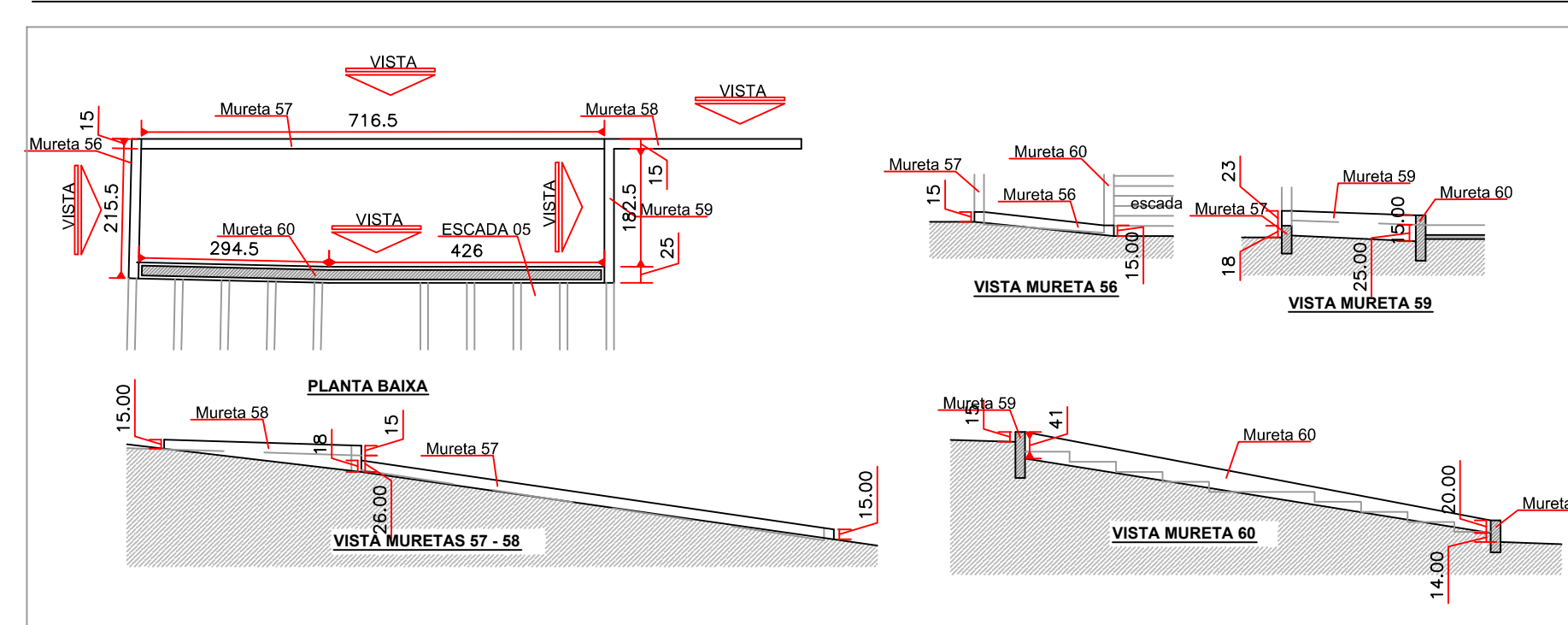

**MURETAS 61 - 62 - 63 concreto armado**

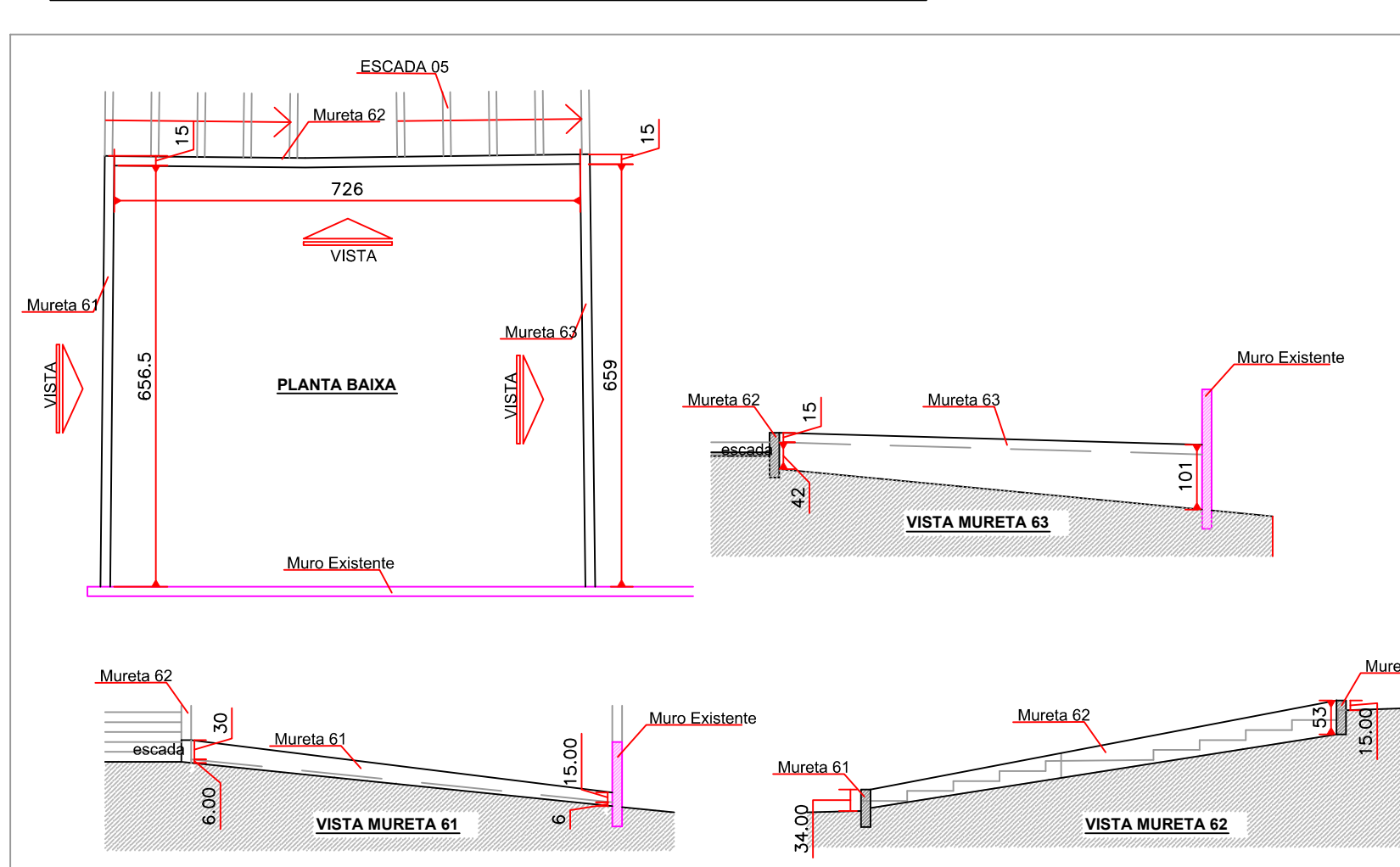

**MURETAS 64 - 65 - 66 - 67 - 68 - 69 - 70 concreto armado**

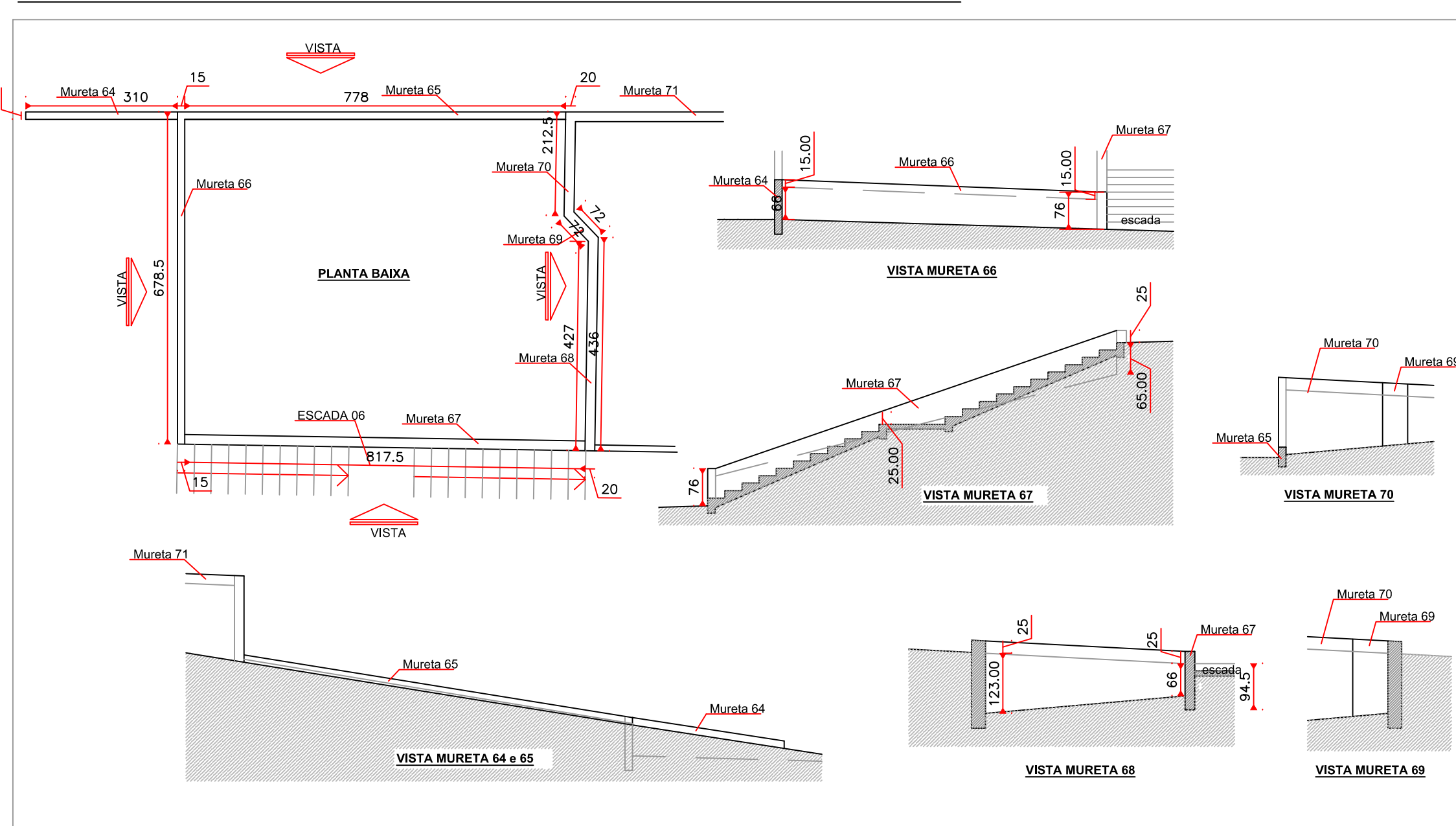

**MURETA 71 concreto armado**

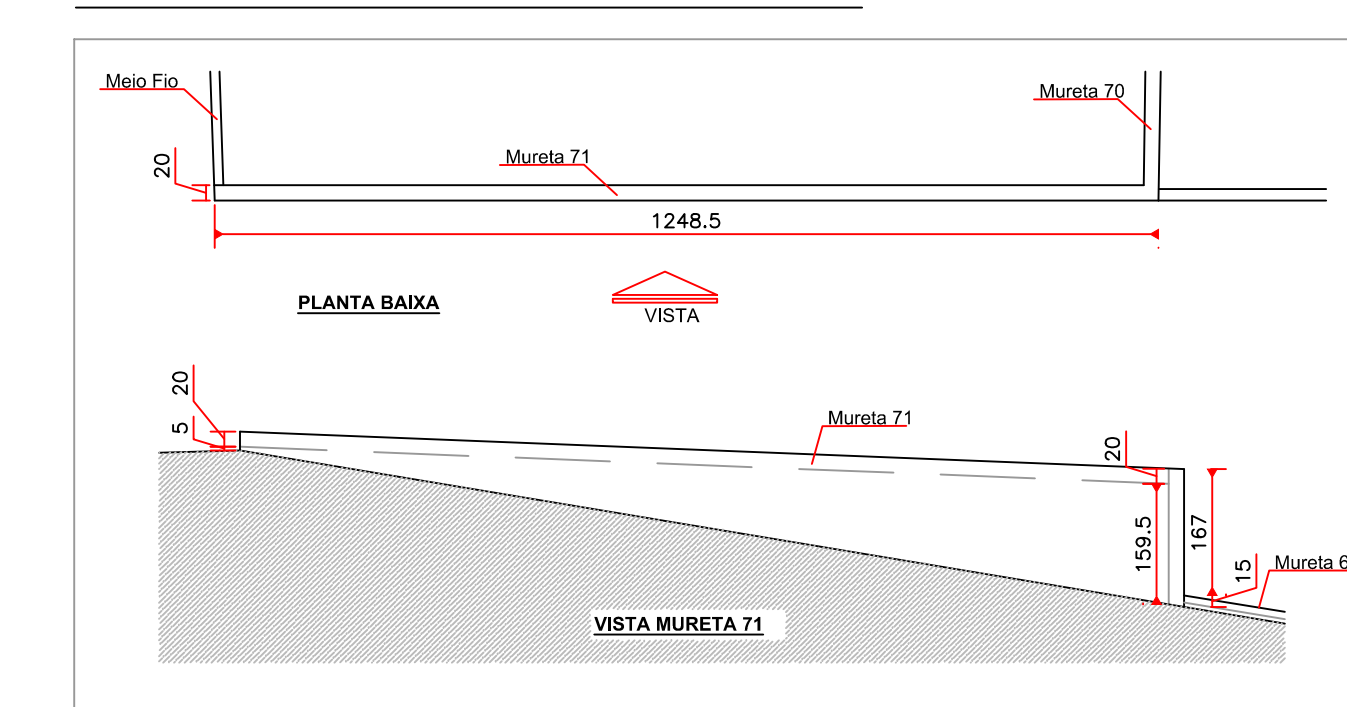

**MURETAS 72 - 73 - 74 concreto armado**

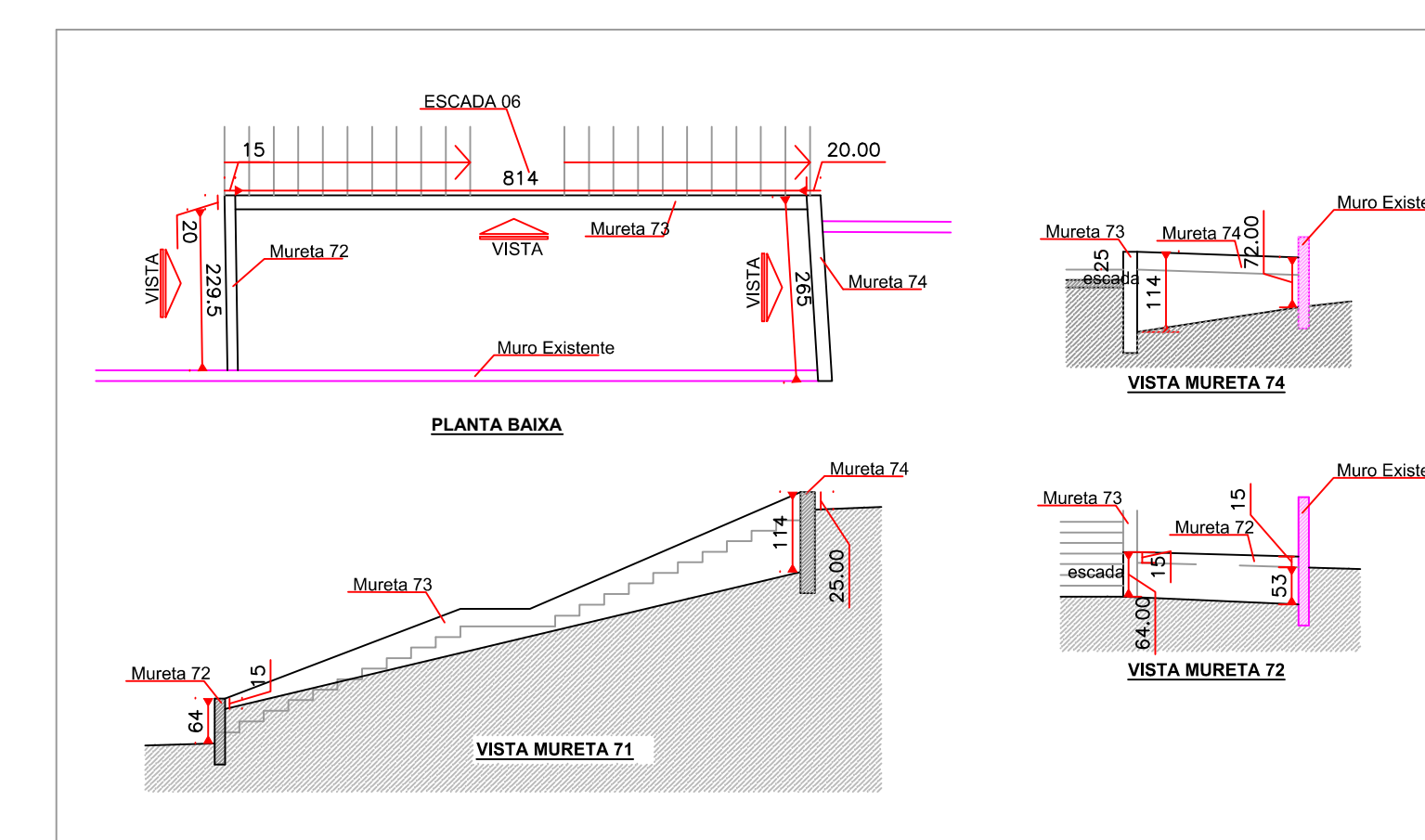

<p><b>AMURES</b></p>		<p>ASSOCIAÇÃO DE MUNICÍPIOS DA REGIÃO SERRANA</p>	
<p><b>PREFEITURA MUNICIPAL DE BOM RETIRO</b></p>		<p><b>8/13</b></p>	
<p>PROJETO: <b>Elisiane Grudner</b> CAU-A 17356-8 RRY 5838321</p>		<p>OBRA: <b>PRAÇA DOM DANIEL</b> PROJETO ARQUITETÔNICO <b>Muretas 44 a 74</b></p>	
<p>PREFEITO: <b>VILMAR JOSÉ NECKEL</b></p>		<p>Localização: Avenida 24 de Outubro com Rua 14 de Janeiro, Centro Bom Retiro SC</p>	
<p>DESENHO:</p>	<p>TOPOGRAFIA:</p>	<p>Escala:</p>	<p>DATA:</p>
		<p><b>INDICADA</b></p>	<p><b>Junho/2017</b></p>