

MURETA 27 - concreto armado revestido com pedra
MURETA 28 - concreto armado

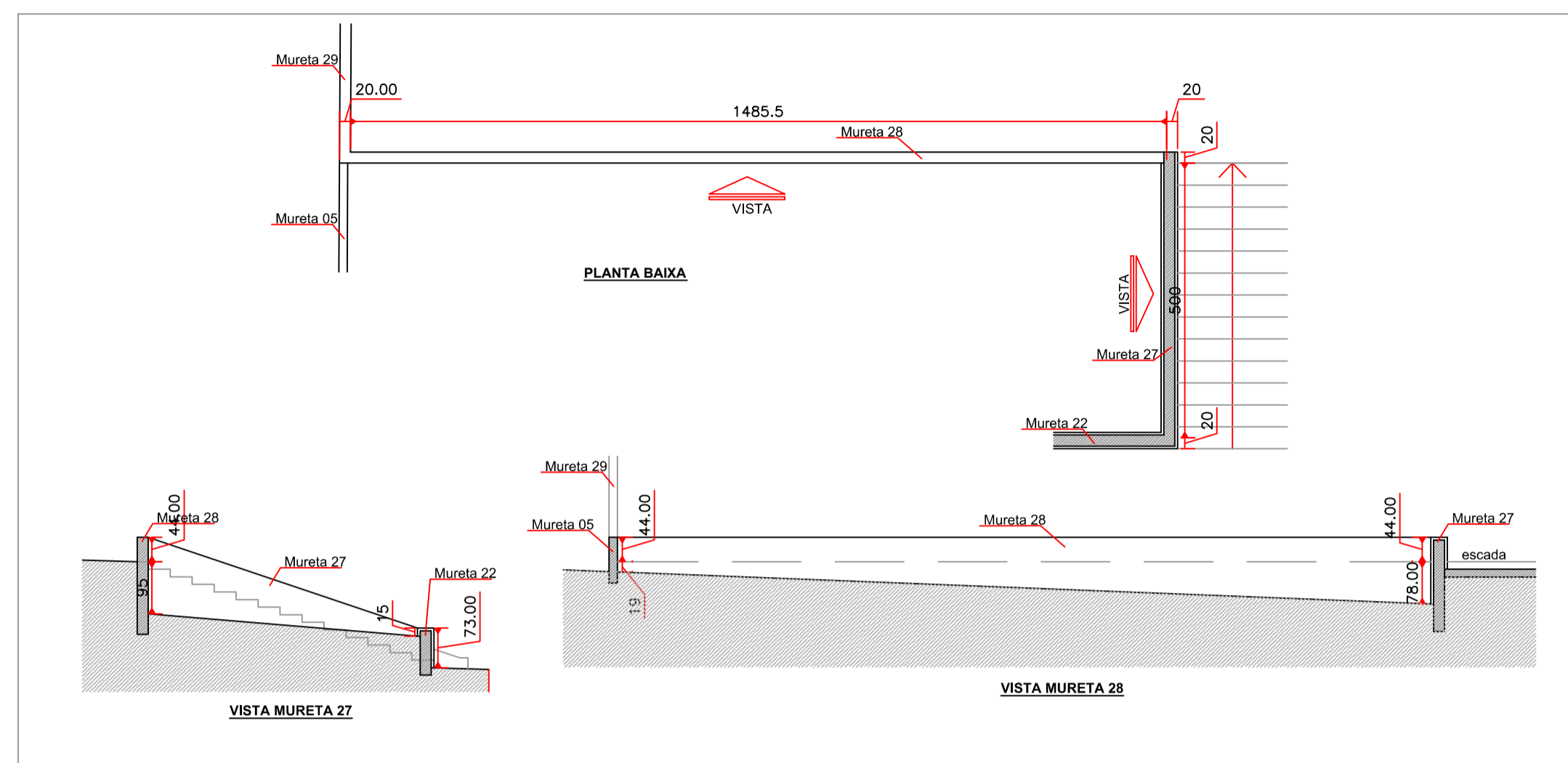

MURETA 29 - 30 - concreto armado

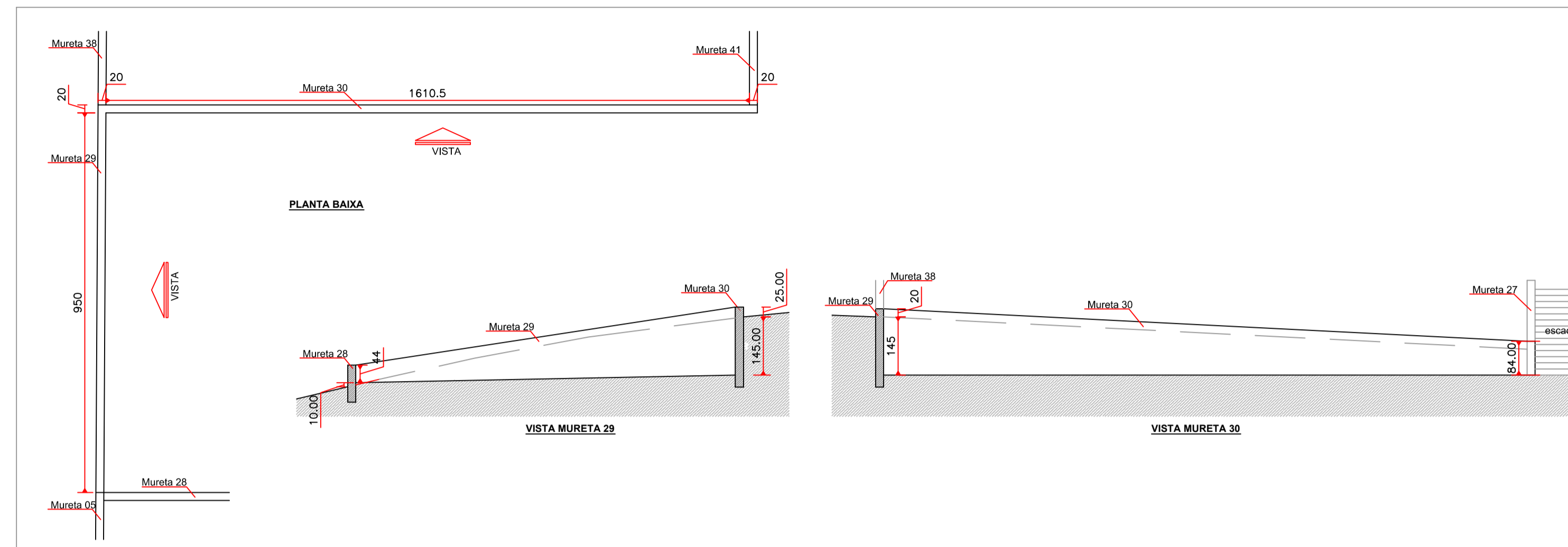

MURETA 31 - concreto armado

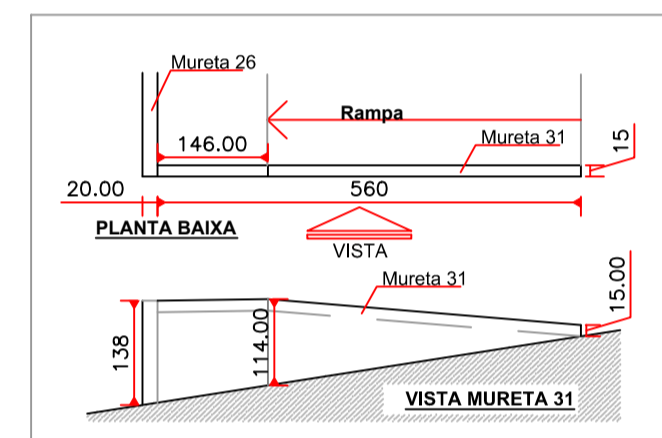

MURETA 32 - 33 - 34 - concreto armado

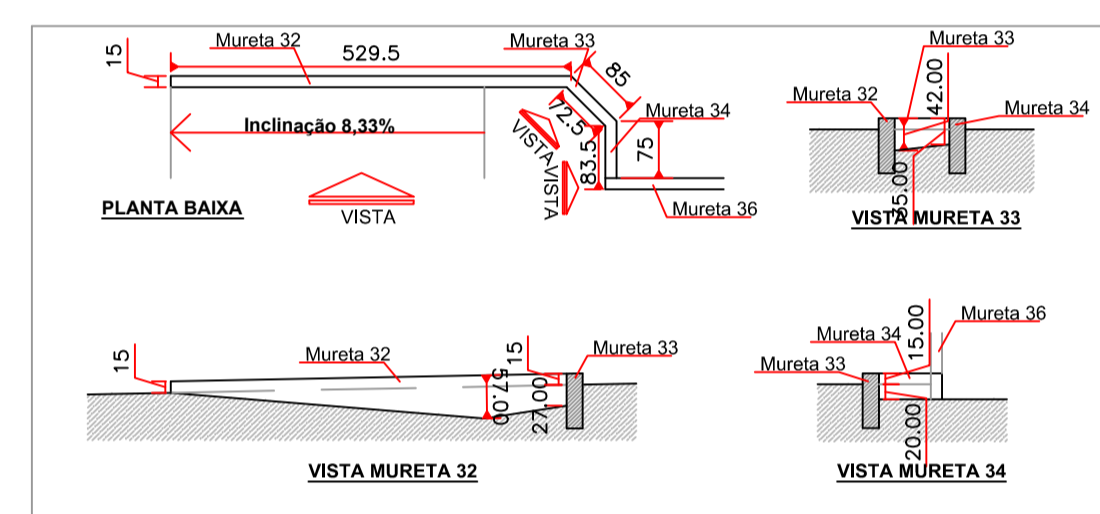

MURETA 35 - 36 - 37 - concreto armado

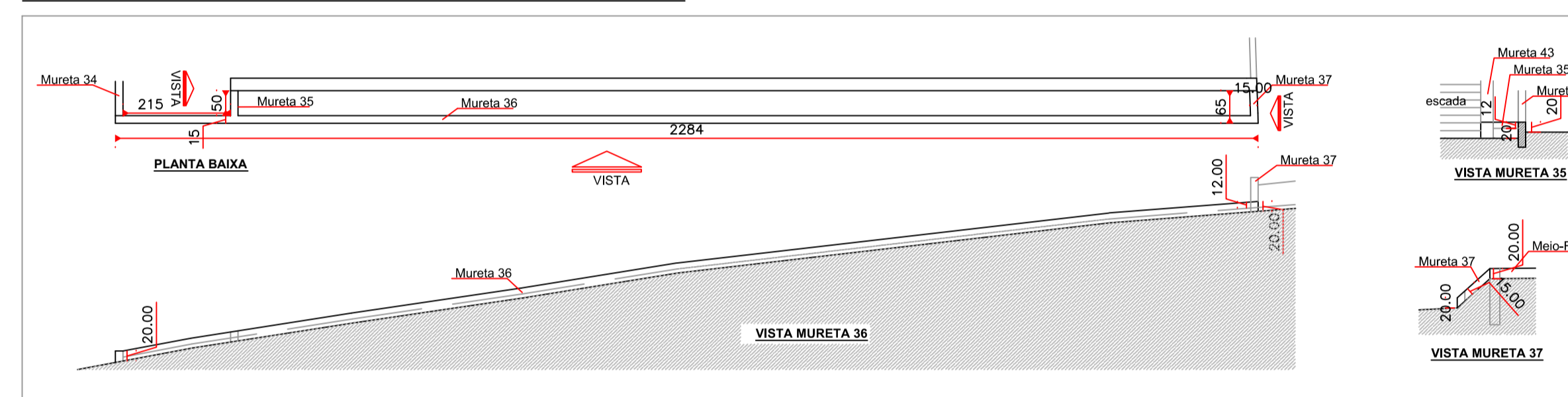

MURETA 38 - 39 - 40 - concreto armado

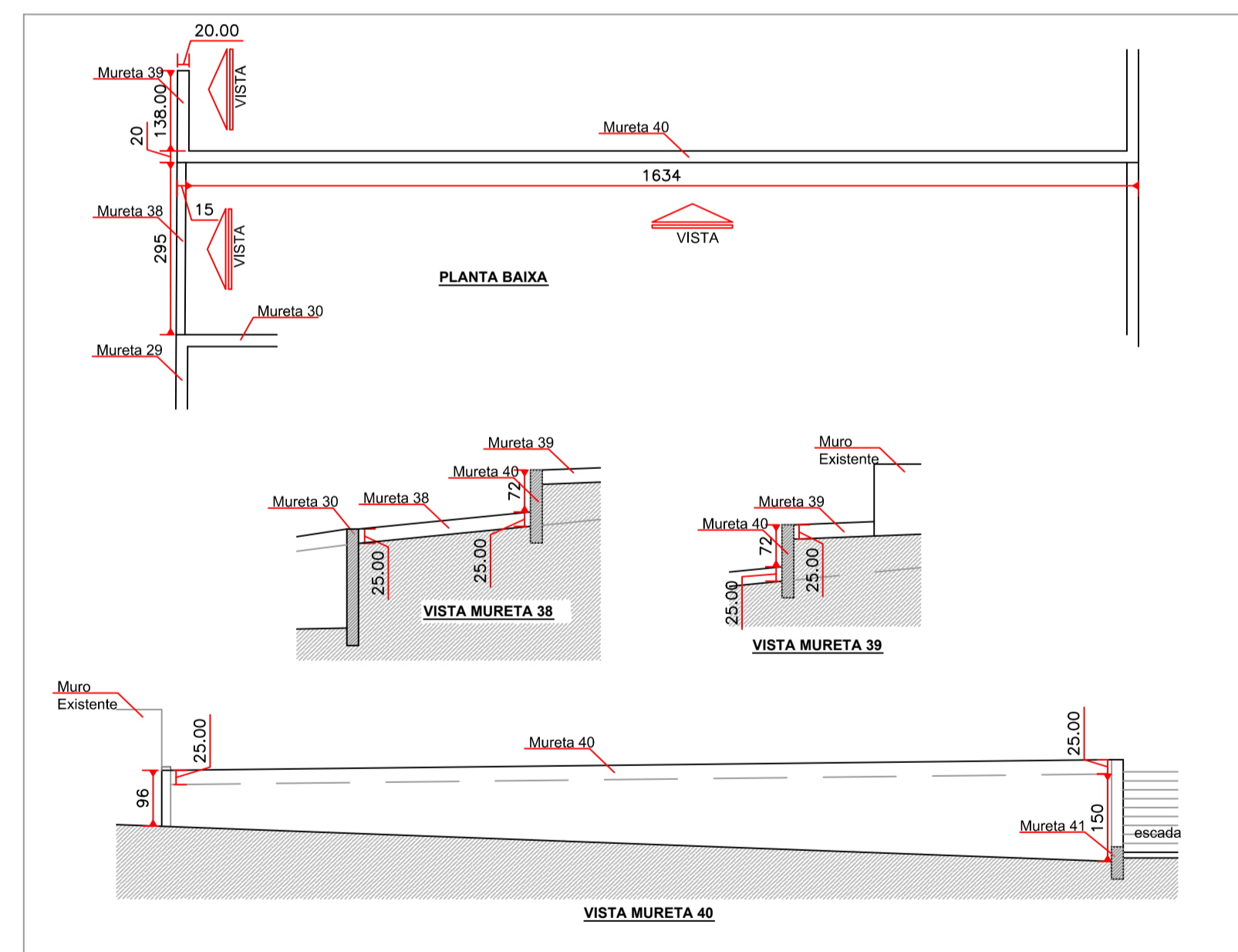

MURETA 41 - 42 - concreto armado

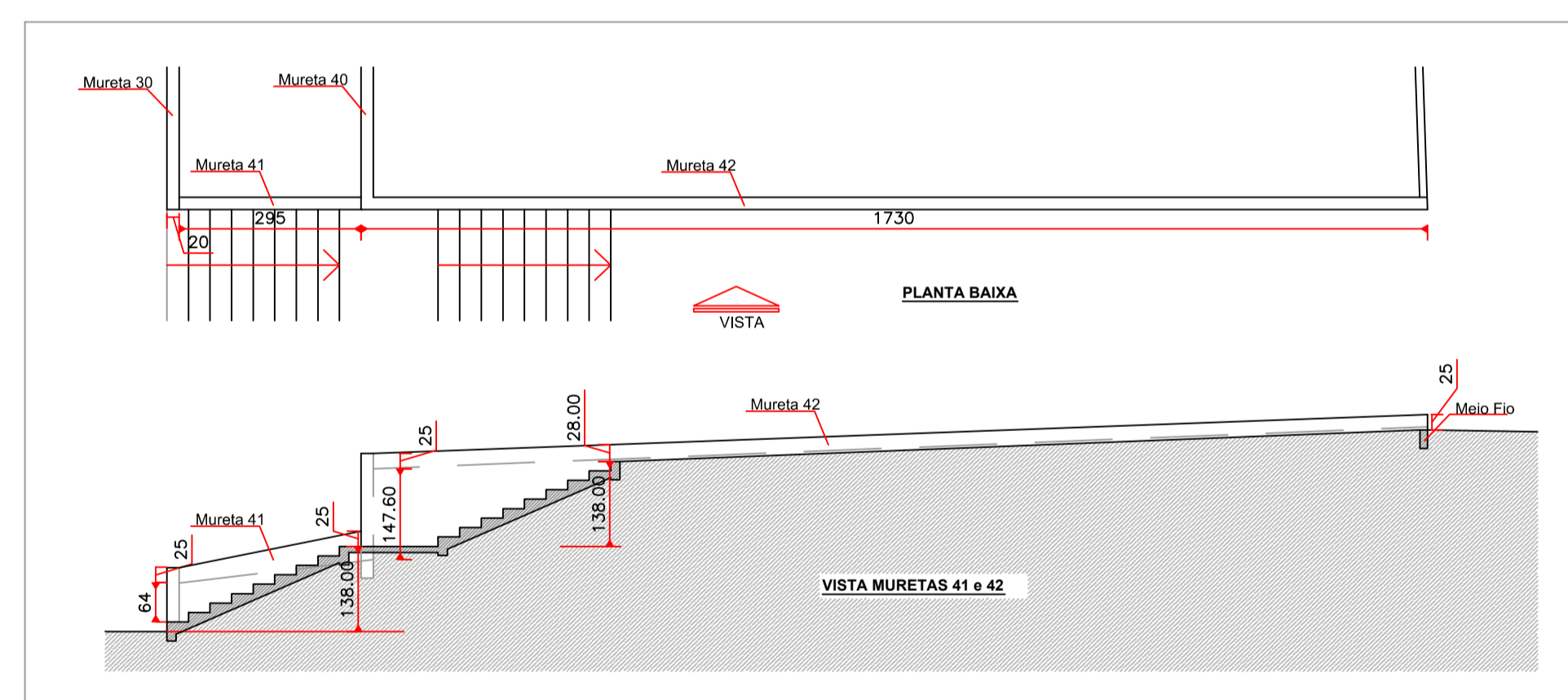

MURETA 43 - concreto armado revestido com pedra

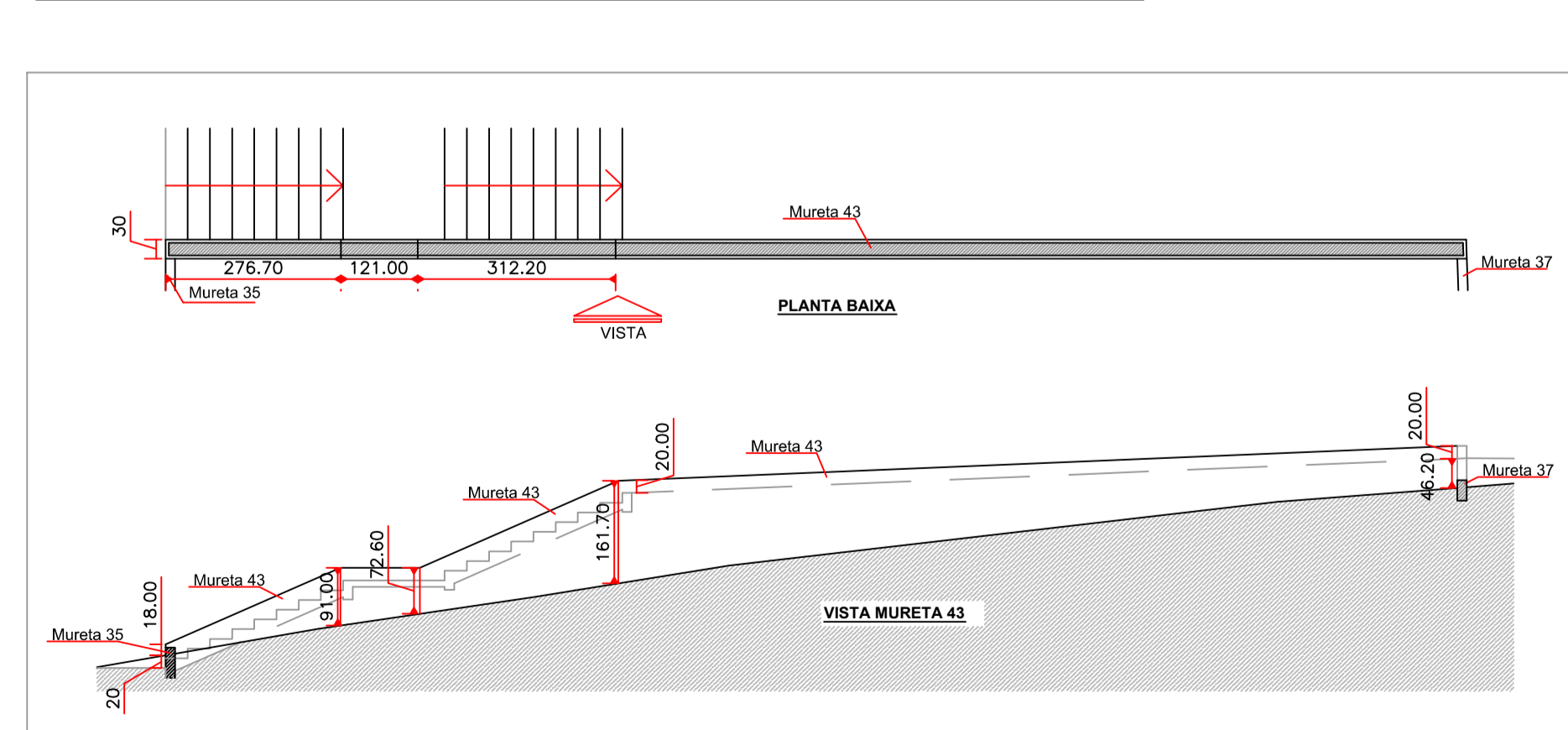

ESCADAS 01 - 02 - 03 - 06 - concreto armado

ESCADAS 04 - 05 - paver e meio fio de concreto pré moldado

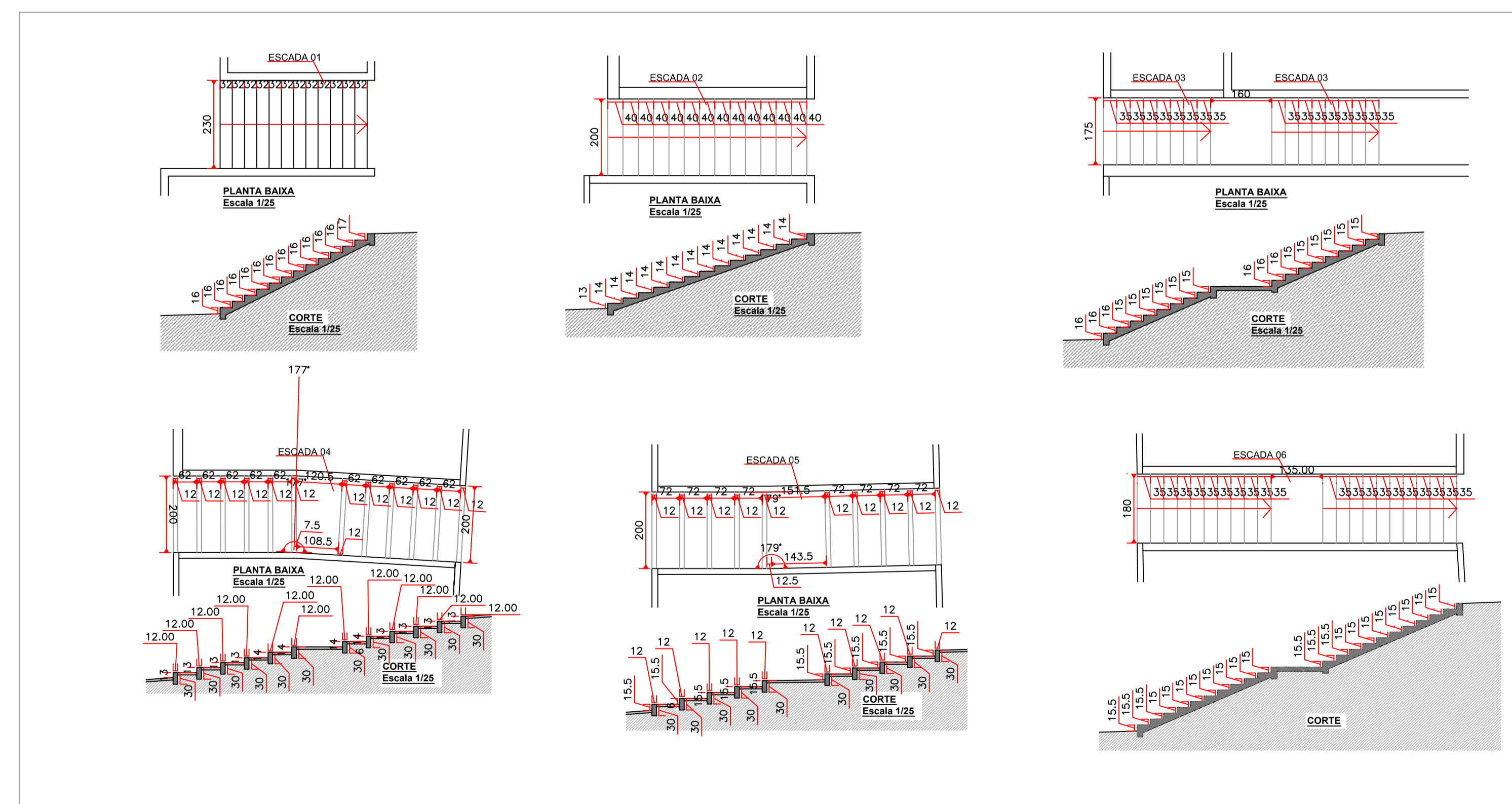

AMURES		ASSOCIAÇÃO DE MUNICÍPIOS DA REGIÃO SERRANA	
PREFEITURA MUNICIPAL DE BOM RETIRO		7/13	
ASSESSORIA TÉCNICA		OBRA	
PROJETO: Elisiane Grudtner CREA 17386-8 RRT 5835321		PRAÇA DOM DANIEL PROJETO ARQUITETÔNICO Muretas 27 a 43 Escadas 01 a 06 Localização: Avenida 24 de Outubro com Rua 14 de Janeiro, Centro Bom Retiro SC	
PREFEITO: VILMAR JOSÉ NECKEL			
DESENHO:	TOPOGRAFIA:	Escala:	DATA:
		INDICADA	Junho/2017