

**MURETAS 01 - 02 - 03 - concreto armado**

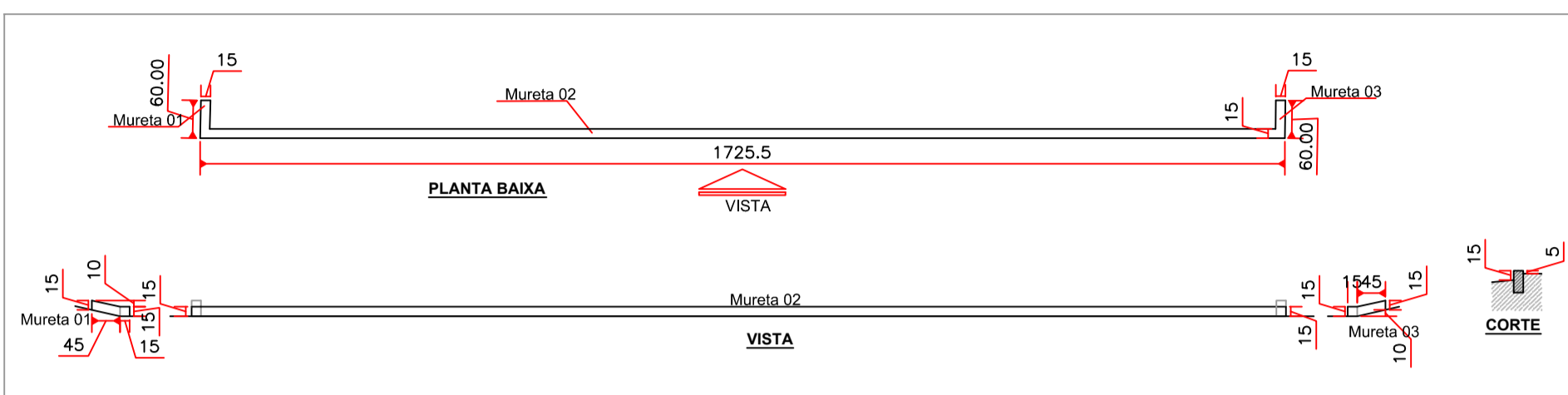

**MURETAS 04 - concreto armado revestido de pedra**

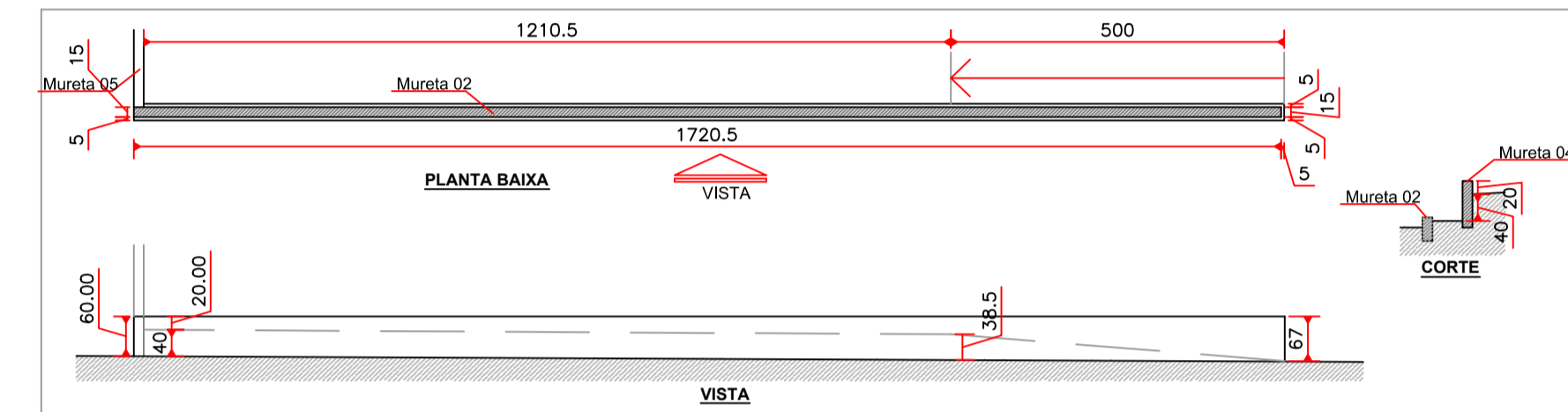

**MURETAS 08 - 09 concreto armado revestida de pedra**

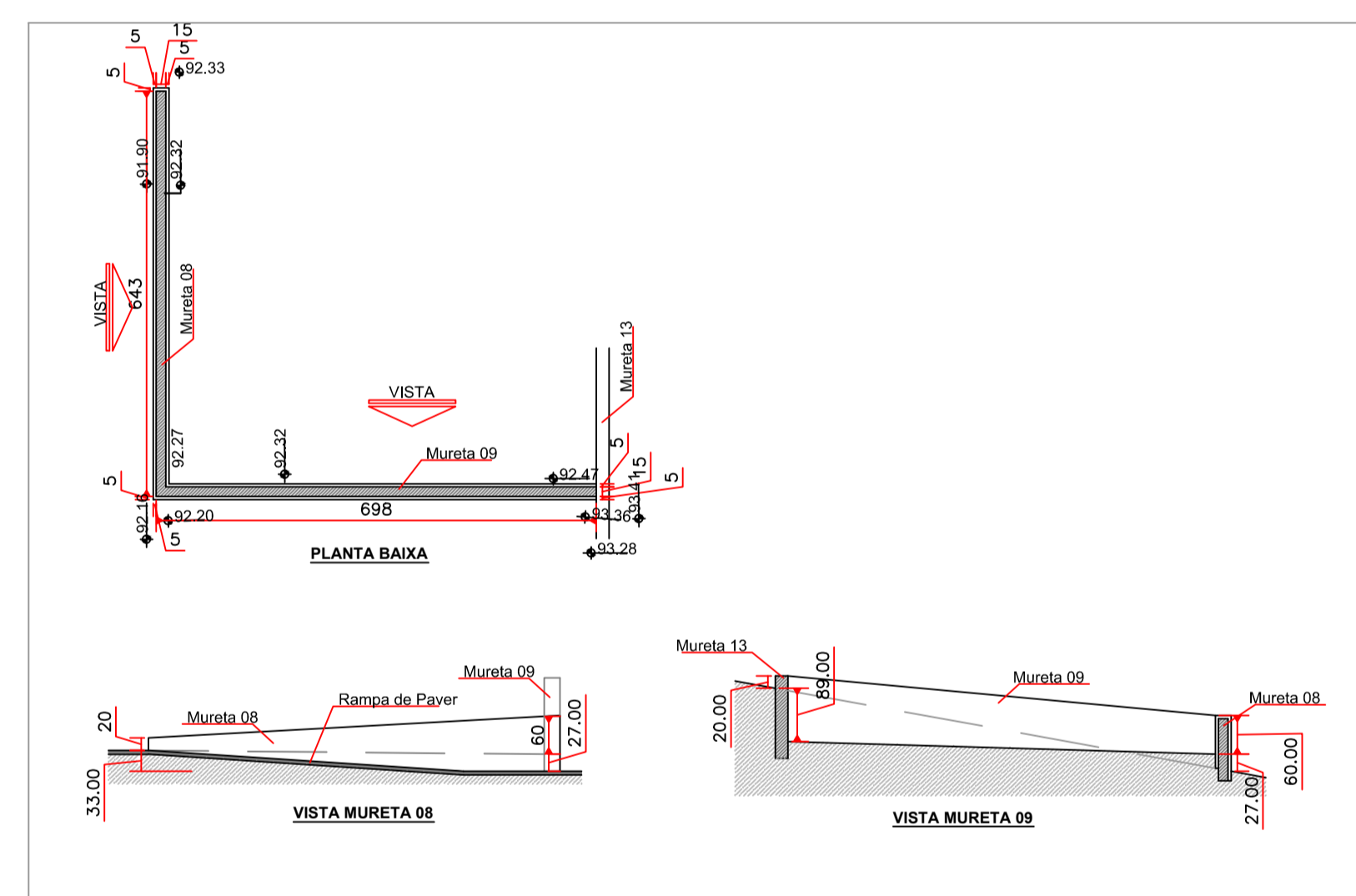

**MURETAS 10 - 11 concreto armado**

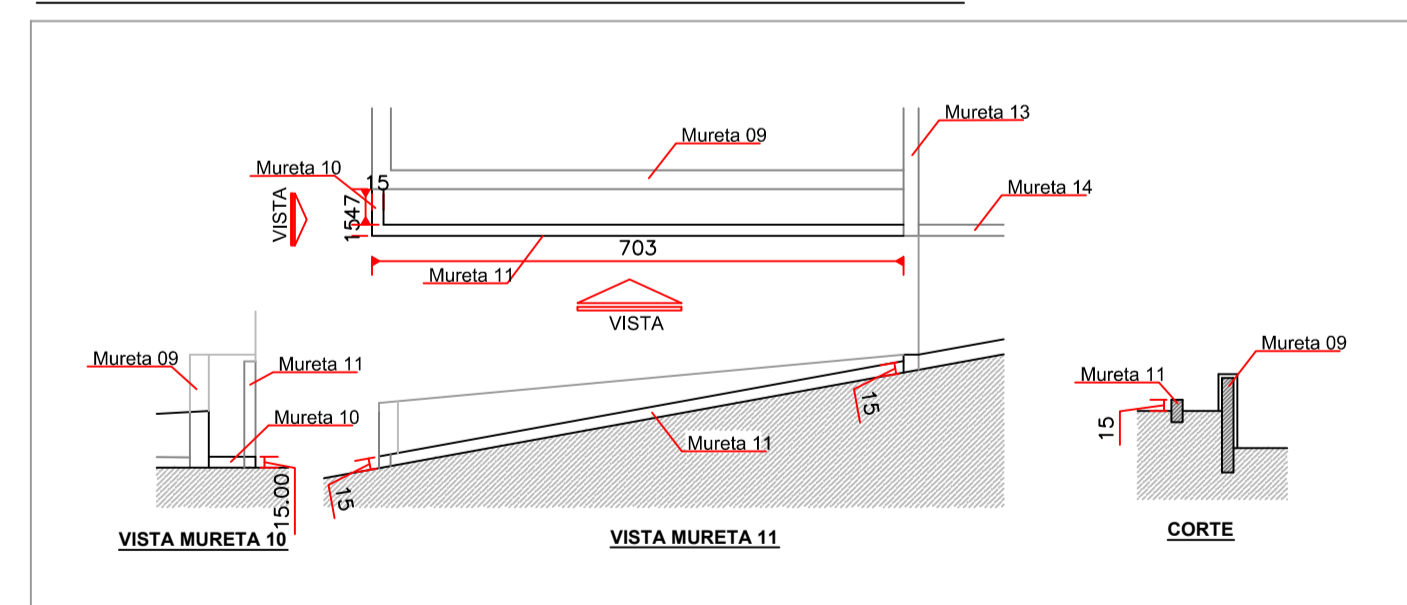

**MURETAS 05 - concreto armado**

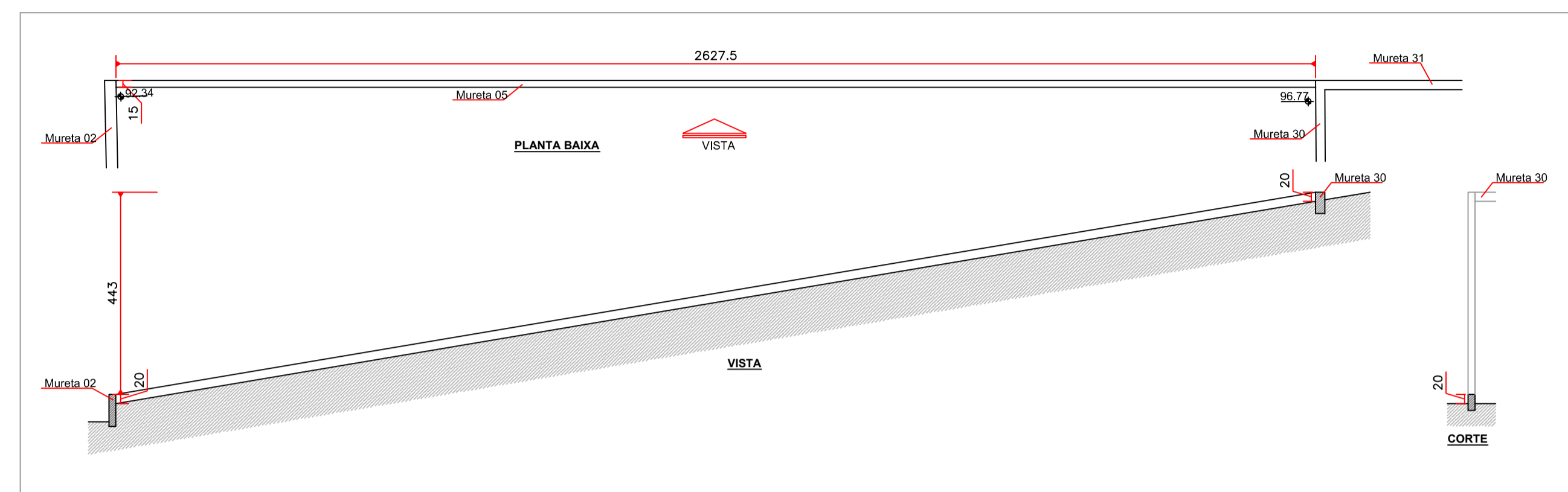

**MURETAS 12 - 13 - 14 concreto armado**

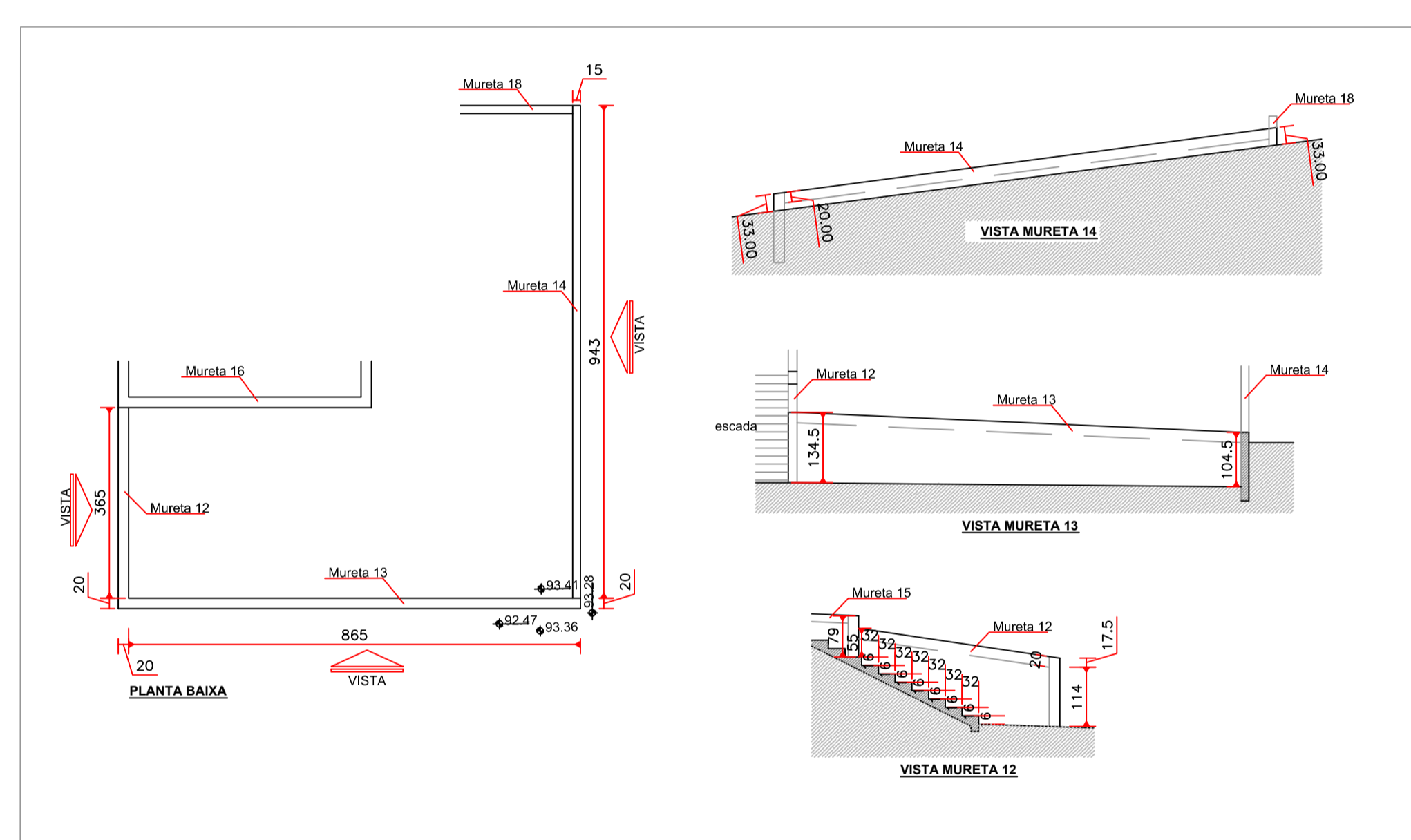

**MURETAS 19 - 20 - 21 concreto armado**

**Mureta 22 - concreto armado revestido com pedra**

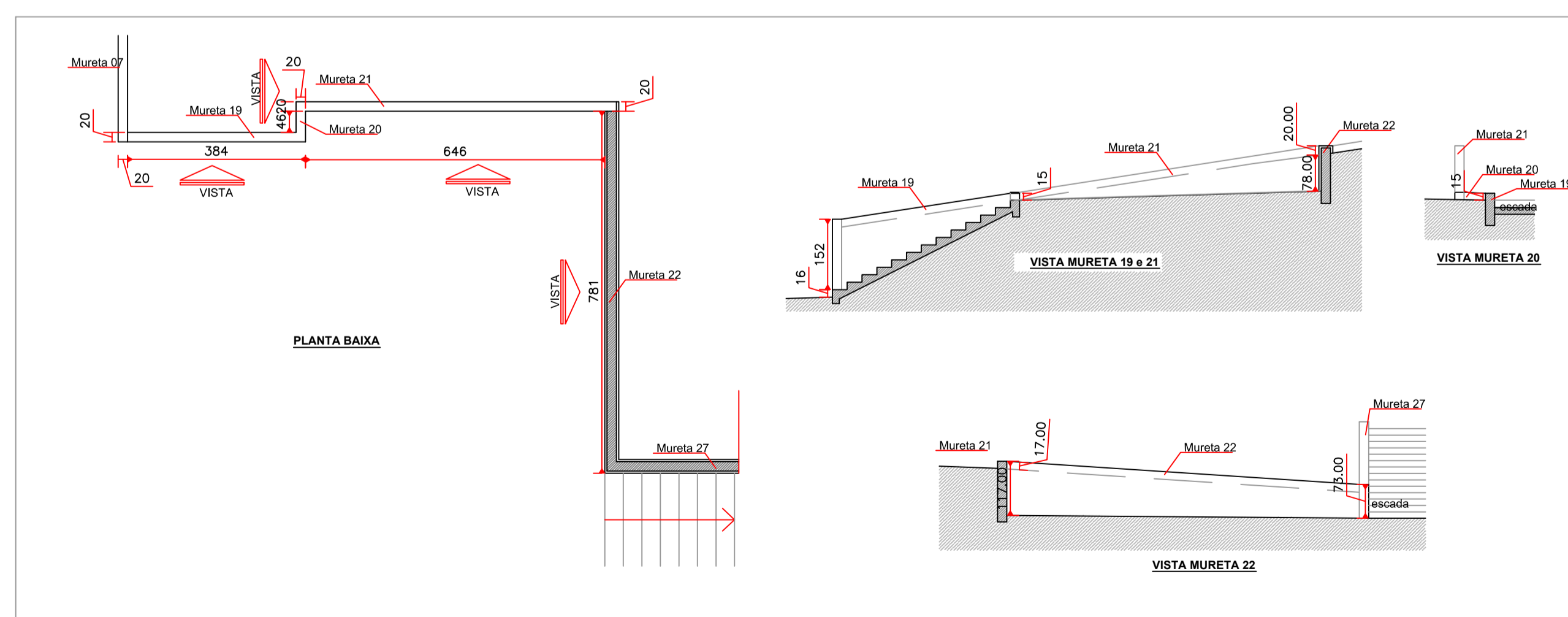

**MURETAS 06 - 07 concreto armado**

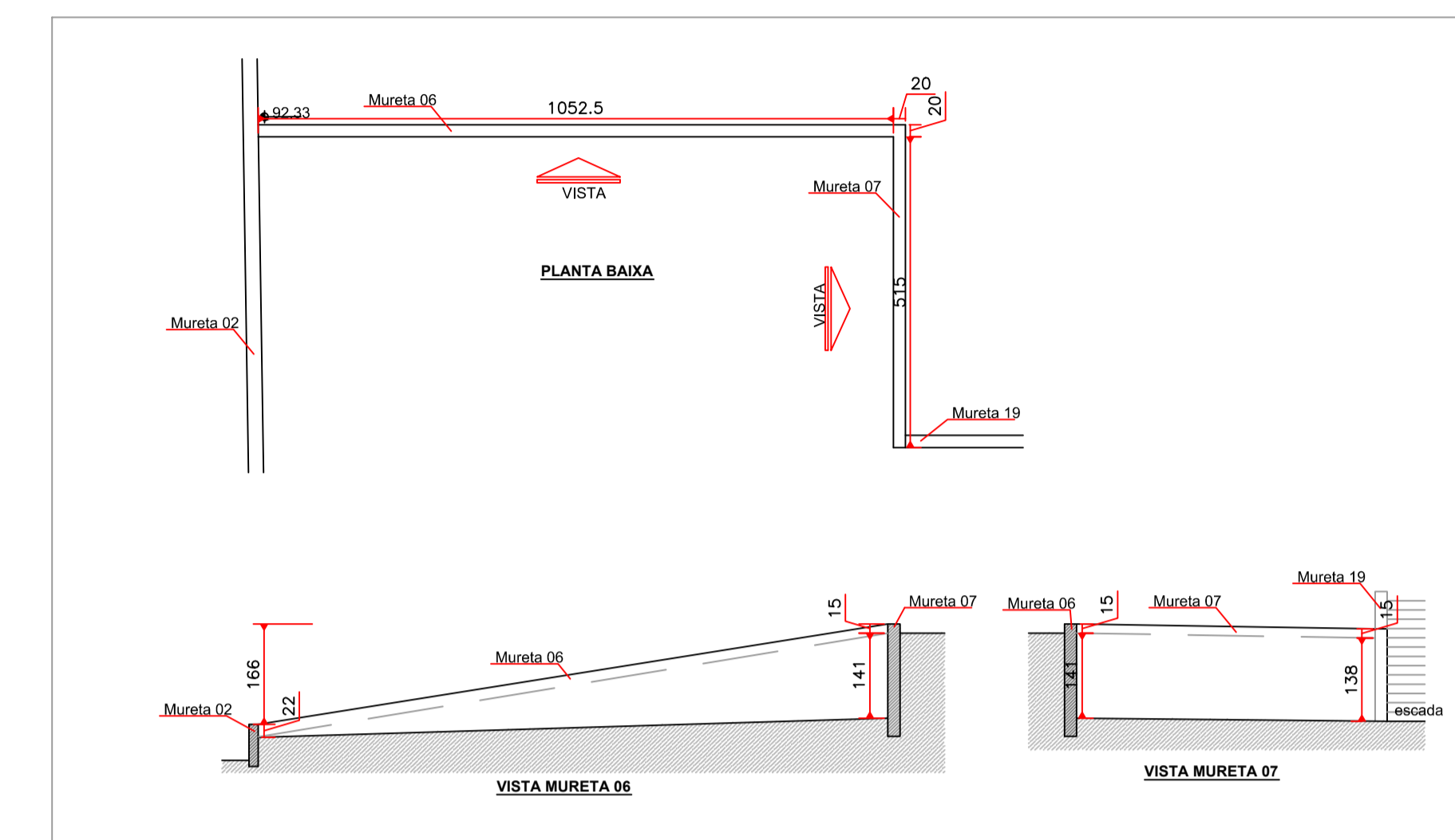

**MURETAS 15 - 16 - 17 - 18 - concreto armado**

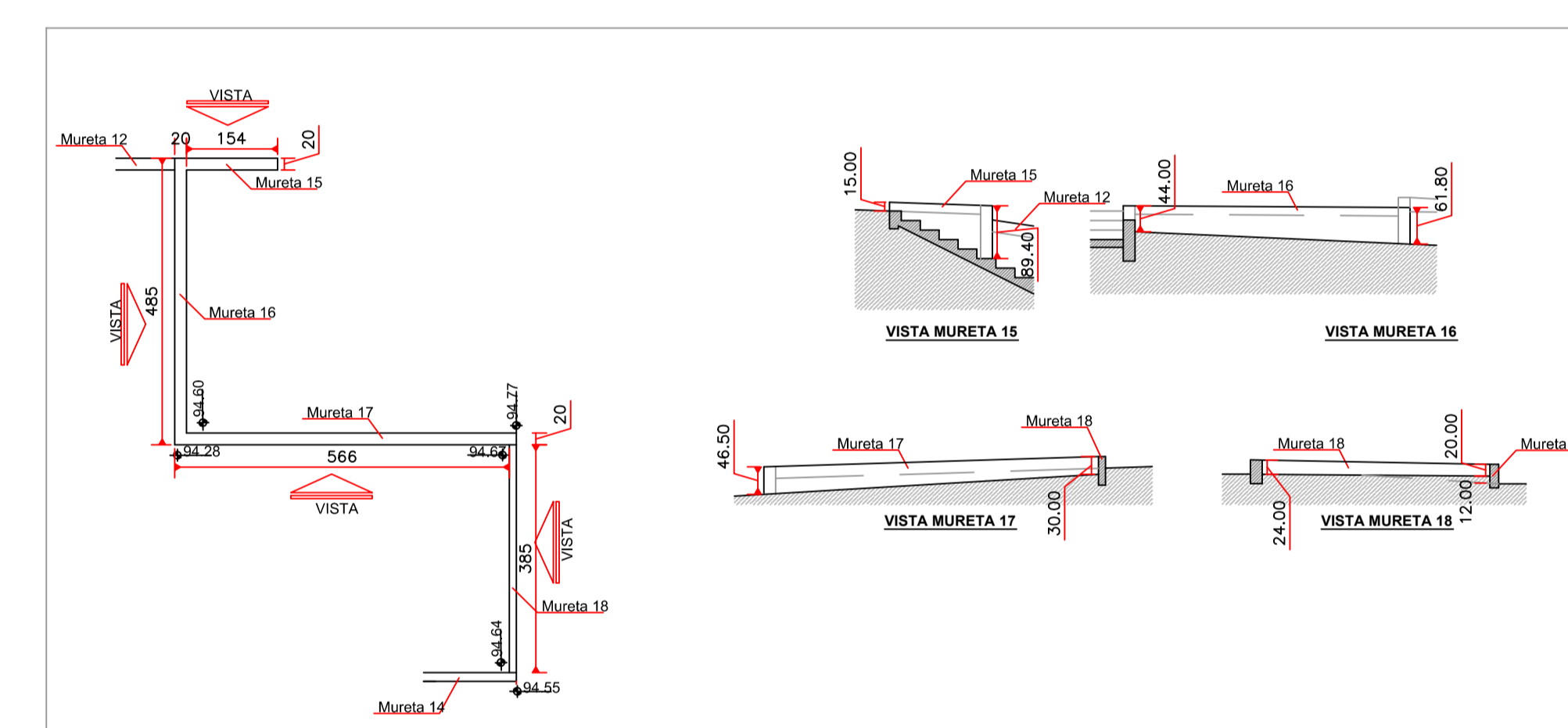

**MURETAS 23 - 24 - 25 - 26 concreto armado**

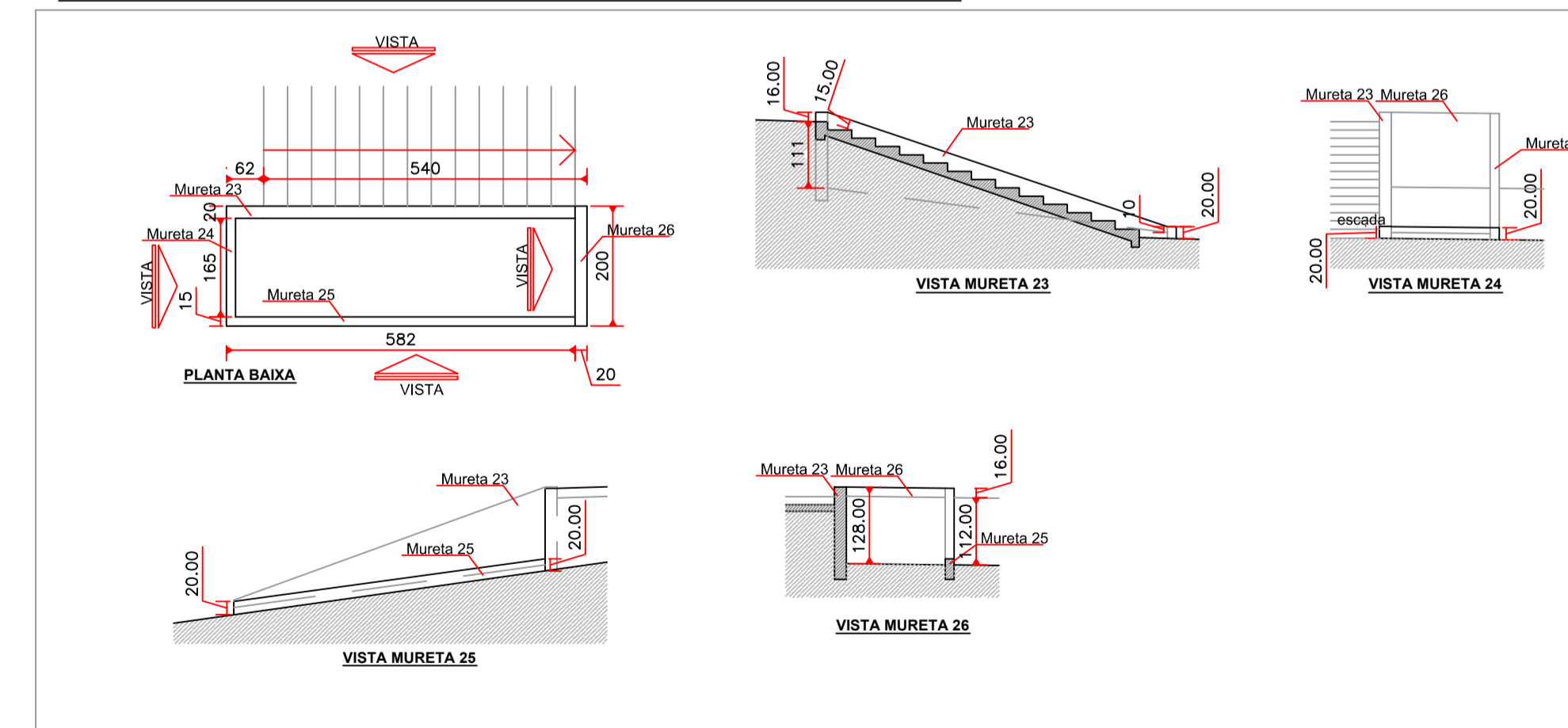

<b>AMURES</b>		ASSOCIAÇÃO DE MUNICÍPIOS DA REGIÃO SERRANA	
<b>PREFEITURA MUNICIPAL DE BOM RETIRO</b>		<b>6/13</b>	
<b>ASSESSORIA TÉCNICA</b>		<b>OBRA:</b>	
PROJETO: Elisiane Grudtner CAD: A 17286-8 RRT 5838321		<b>PRAÇA DOM DANIEL</b>  <b>PROJETO ARQUITETÔNICO</b>  <b>Muretas 01 a 26</b>  Localização: Avenida 24 de Outubro com Rua 14 de Janeiro, Centro Bom Retiro SC	
PREFEITO: <b>VILMAR JOSÉ NECKEL</b>			
DESENHO:	TOPOGRAFIA:	Escala:	DATA:
		INDICADA	Junho/2017